

TANKRING LOCK-IT

Below you will find a checklist for our tank rings.

Measure the distances between the screws as shown in the sketch. When you have found your item number, you can enter it in the search field above and find the tank ring to order.

Generally you only need a model-specific tank ring and a tank bag. No other adapters are required.

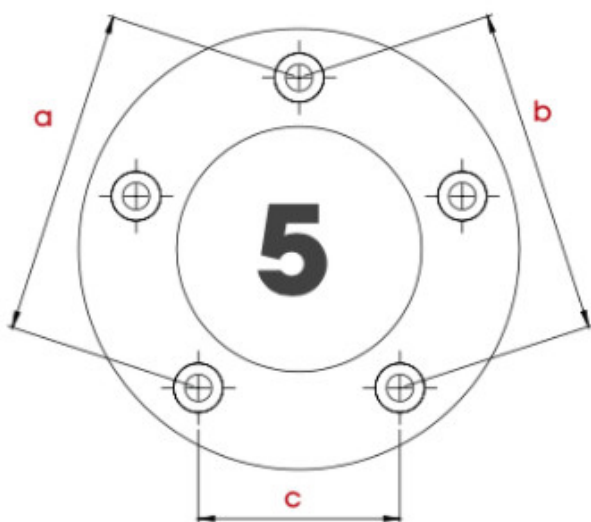

Art.Nr.	Ø	a	b	c
506002-5	5	91,3	91,3	56,4
506006-5	5	83,0	83,0	64,2
506010-5	5	84,6	84,6	60,0
506012-5	4	79,0	79,0	49,0
506013-5	4	81,5	81,5	60,8
506014-5	5	96,0	96,0	59,4

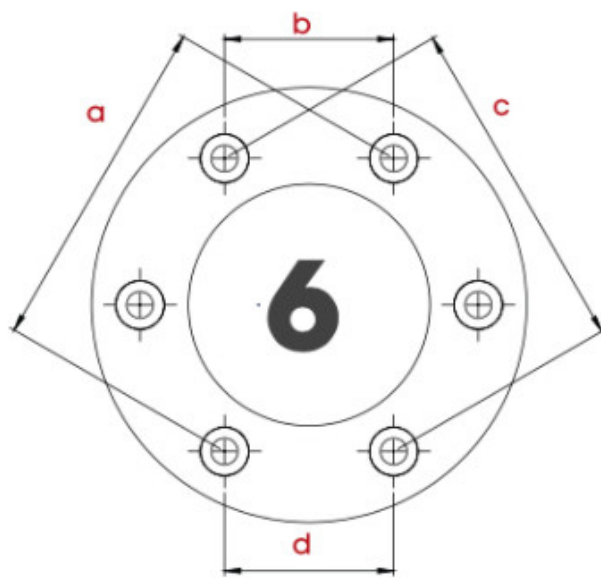

Art.Nr.	Ø	a	b	c	d
506001-6	5	88,0	44,0	88,0	44,0
506003-6	5	100	50,0	100	50,0

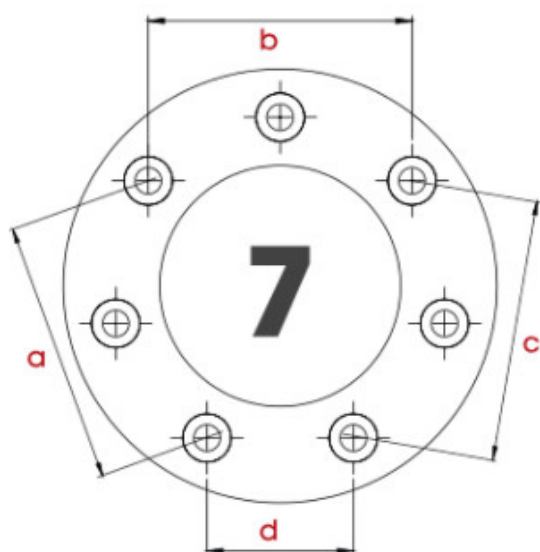

Art.Nr.	Ø	a	b	c	d
506007-7	4/6	74,3	74,3	74,3	57,3
506008-7	5	75,0	75,0	75,0	41,6
506009-7	5	83,2	83,2	83,2	63,6
506011-7	5	74,6	74,6	74,6	41,4
506016-7	5	74,6	74,6	74,6	41,4

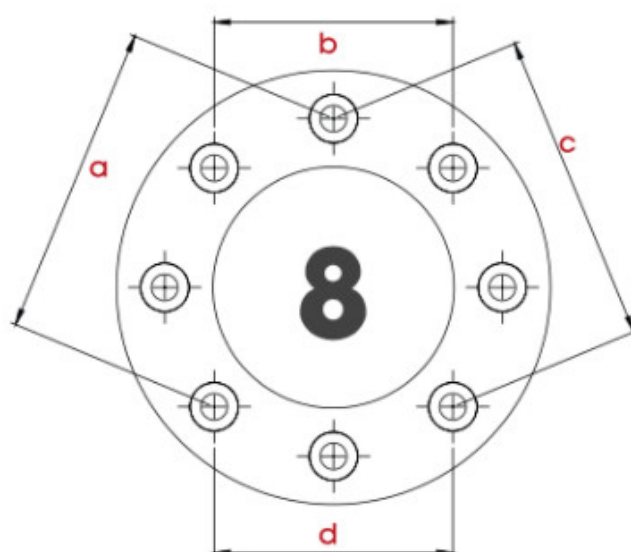

Art.Nr.	Ø	a	b	c	d
506009-8	5	83,2	63,6	83,2	63,6